

- 
- DE Montageanleitung**
 - EN Assembly instructions**
 - FR Notice de montage**
 - NL Montage-instructies**
 - IT Istruzioni di montaggio**
 - ES Instrucciones de montaje**
 - PL Instrukcja montażu**
 - CZ Návod k montáži**
 - SK Pokyny na montáž**
 - SE Monteringsanvisningar**
 - RO Instrucțiuni de montaj**

Montageanleitung 1,2,3,4,5,6,7,8,9

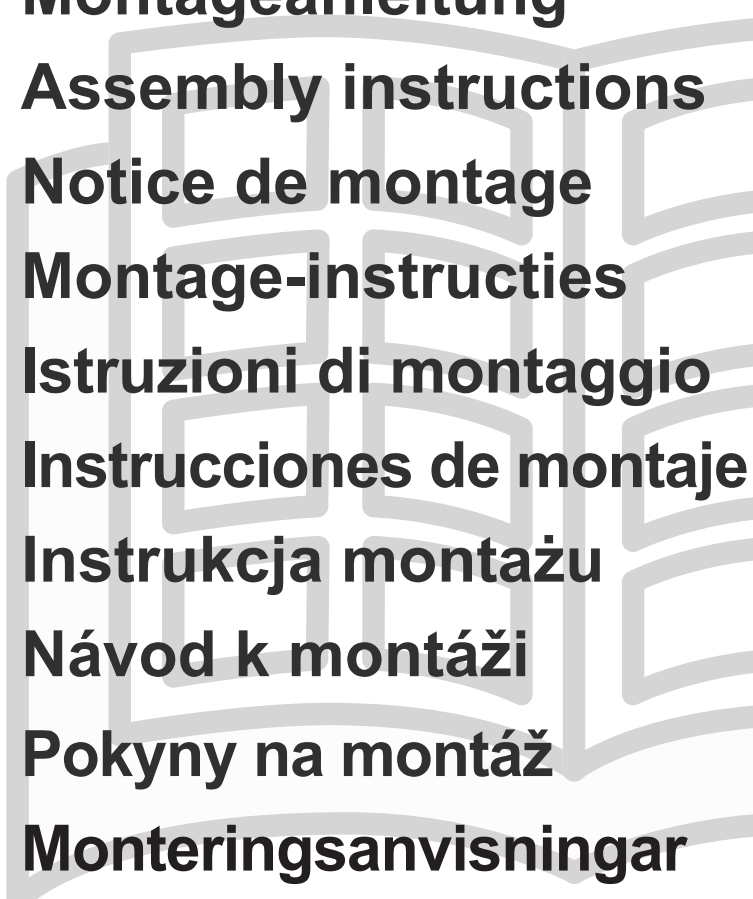

TECKENTRUP

DOOR SOLUTIONS

Luminaire:
Model: 1799004779
Input: SELV 24V=Volt (Spannung) \equiv
Rated power: 72W=Watt (Leistung)



With LED driver
Model: GQ72-240300-E2
Input: 100-240V~50/60Hz 1.2A Max
Output: 24V \equiv 3.0A, 72W

 **IP20**

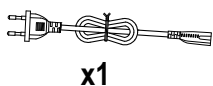

x1



x1

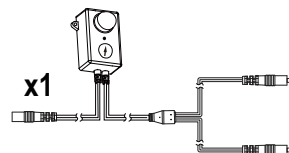

x1



x2

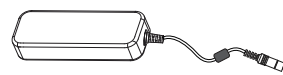

x1



x6

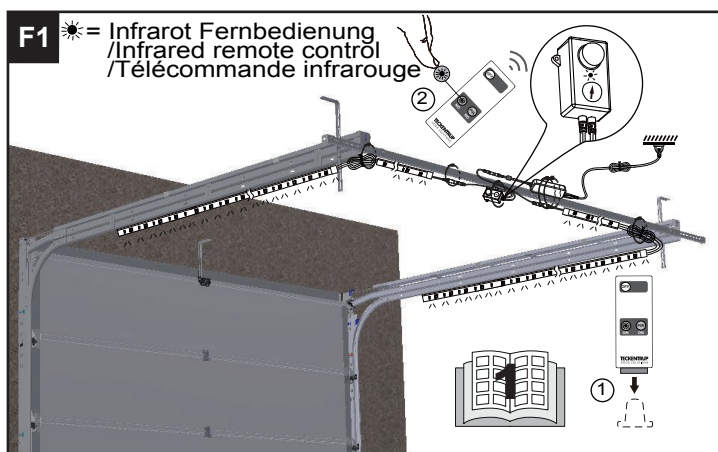
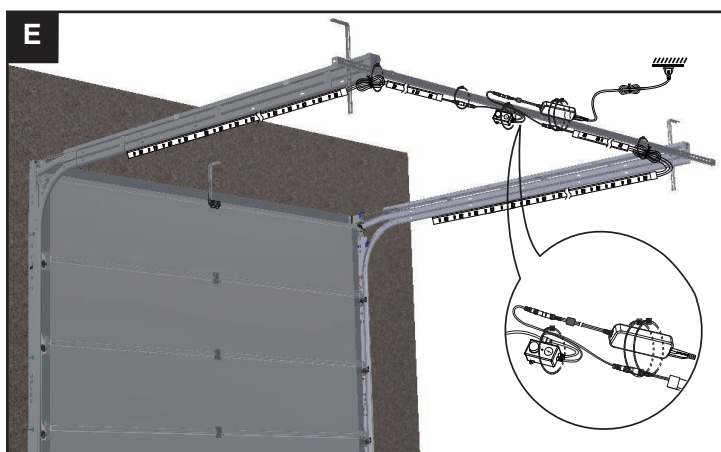
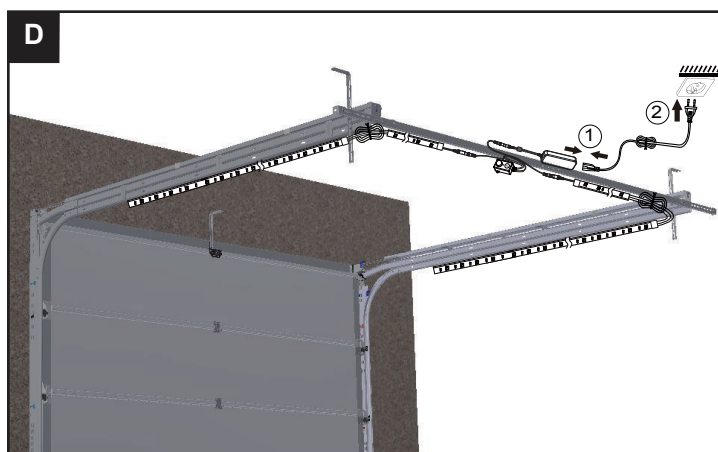
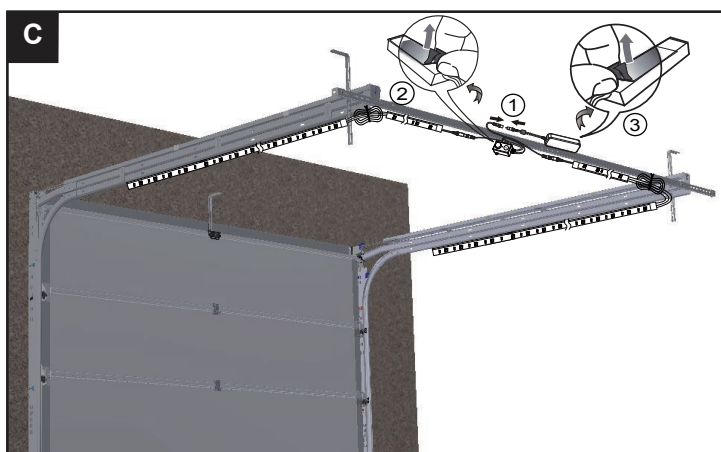
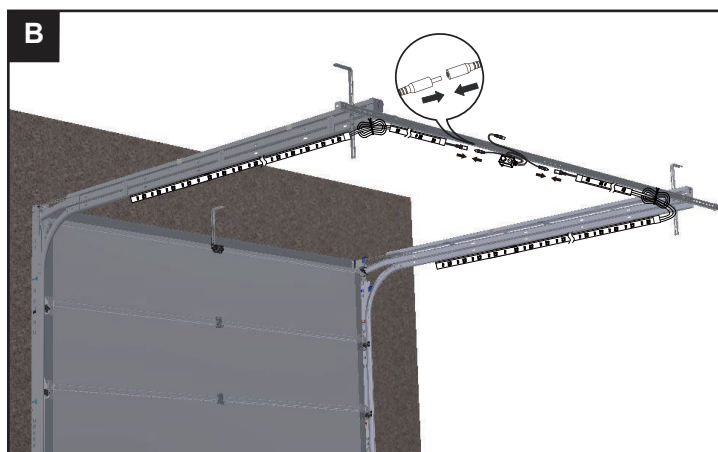
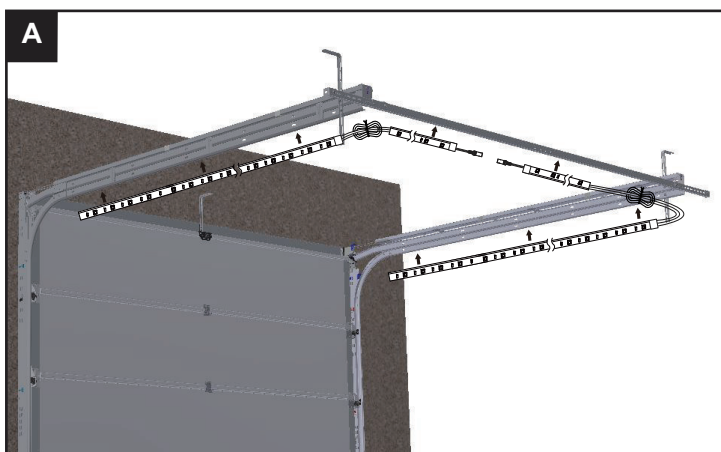

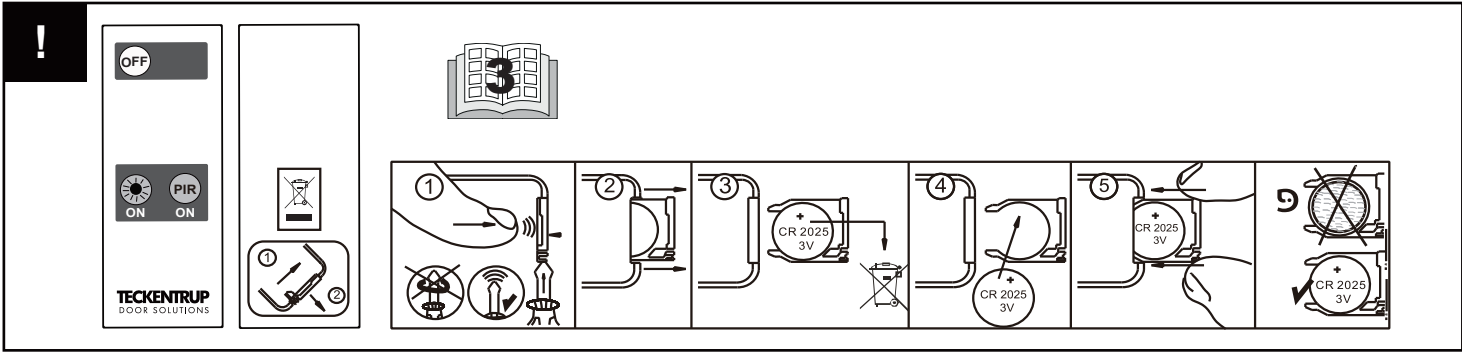
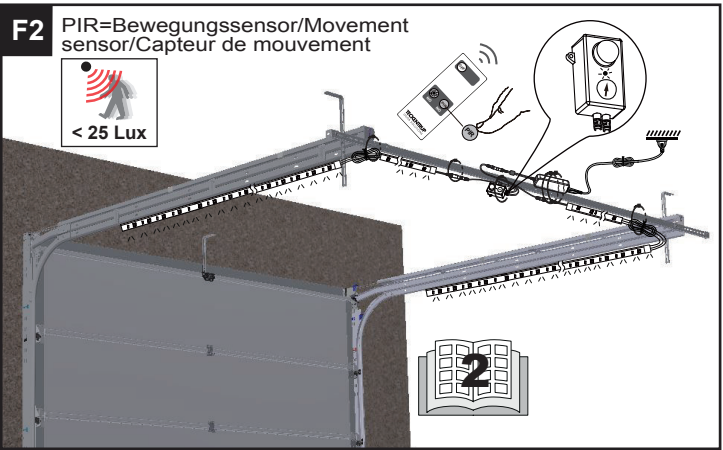

User instructions:



- 1) Remove the transparent insulating sheet of battery from remote control before using.
- 2) Press the "☀" button, then LED strips will be lightened.
- 3) If you want to switch off the LED system, please press the "OFF" button and then the light will be off.



- 1) Press the PIR button, then LED strip will be lightened according to time setting and when the brightness of surrounding is less than 25 lux.
- 2) If the PIR sensor gets a new inductive signal, the LED strip will be lightened again and will hold the working time according your time setting.
- 3) If you want to switch off the LED system, please press the "OFF" button.
- 4) Time setting (60s-10min.) by turning the knob anticlockwise.



Button battery replacement instructions:

- 1) Use a screwdriver to press down the battery holder as shown.
- 2) Take out the battery holder with expired battery.
- 3) The expired battery should not be thrown out with household rubbish. Please follow the notes on battery disposal.
- 4) Replace a new battery on the battery holder.
- 5) Insert battery holder into the remote control.

Please pay attention to the installation direction of battery during its replacement.



Safety instructions:

The following instructions are essential for proper installation, assembly, mounting and operation. Please keep these instructions for future reference! Always refer to the technical data on the product. Subject to technical alterations. Please read the following (safety) instructions carefully!

1. If you are not confident carrying out the installation or assembly yourself, or if there is no access to the mains at the desired installation point, you must have a qualified electrician assist you.
2. The light source of this luminaire cannot be replaced, when the light source has reached the end of its service life, the entire luminaire must be replaced.
3. Please only use the LED driver which provided with this LED strip.
4. Do not connect this LED strip to the supply while it is in the packing.
5. Electrostatic charges can damage or destroy the LED. Do not touch the LED chip, LED contacts, conductors or connector pins.
6. For indoor use only.
7. Do not bend, crush or pull the cable, protect from sharp edges, oil and heat.
8. If the power cable is damaged, the product is unusable.
9. We are not liable for damage caused by improper use, handling, installation, modification or alteration, nor is it covered by the guarantee/warranty.



For indoor use only



Class III product



Class II LED driver



CE conformity marking

The manufacturer shall certify with an EC declaration of conformity, that the product complies with all applicable European Community Directives.



Environmentally friendly disposal

Old electrical appliances must not be disposed of together with the residual waste, but have to be disposed of separately. The disposal at the communal collecting point via private persons is for free. The owner of old appliances is responsible to bring the appliances to these collecting points or to similar collection points. With this little personal effort, you contribute to recycle valuable raw materials and the treatment of toxic substances.



Notes on battery disposal:

The symbol means that batteries should not be thrown out with household rubbish. Consumers are obligated legally to return old batteries. Used batteries have to be returned free of charge to the sales outlet or other collection points. The collecting and recycling of batteries are significant elements of the strategy for protecting human health and the environment. Pollution by batteries needs to be reduced to a minimum to thereby contribute to the protection, maintenance and improvement of the quality of the environment.

Exclusion of the warranty

- The lifetime is an average information but it can happen that ten percent of the LEDs will be out of function before the lifetime is reached.
- The glue will slightly change the color after using, which is a normal process and can't be avoided.
- The remote controller is not meant to be a lighting on/off switch, it should only activate or deactivate the IR or PIR sensor function.
- It may happen on few points that the glue layer will come off a little, this is due to normal bending process which can't be avoided.

Please push the layer back on the base after installation.

TECKENTRUP

DOOR SOLUTIONS